

# 護国寺 艸雷庵

平面図 縮尺 1:50

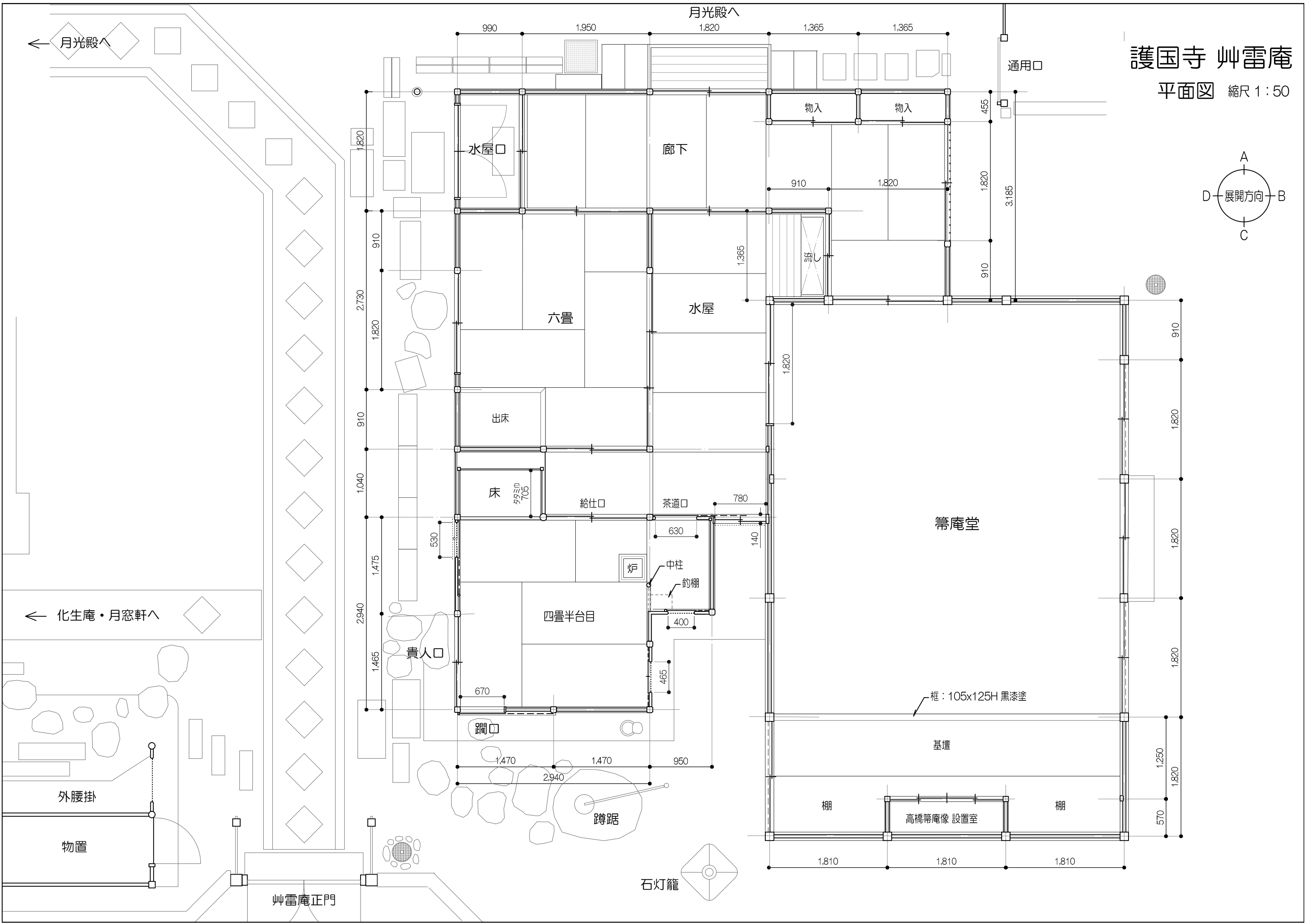
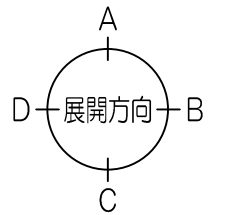

月光殿へ

通用口

物入

物入

水屋口

廊下

流し

六畳

水屋

出床

床

給仕口

茶道口

炉

中柱

釣棚

四畳半台目

貴人口

躰口

蹲踞

簾庵堂

框: 105x125H 黒漆塗

基壇

棚

高橋帚庵像設置室

棚

化生庵・月窓軒へ

外腰掛

物置

艸雷庵正門

石灯笼

# 護国寺 艸雷庵

天井伏図 縮尺 1:50

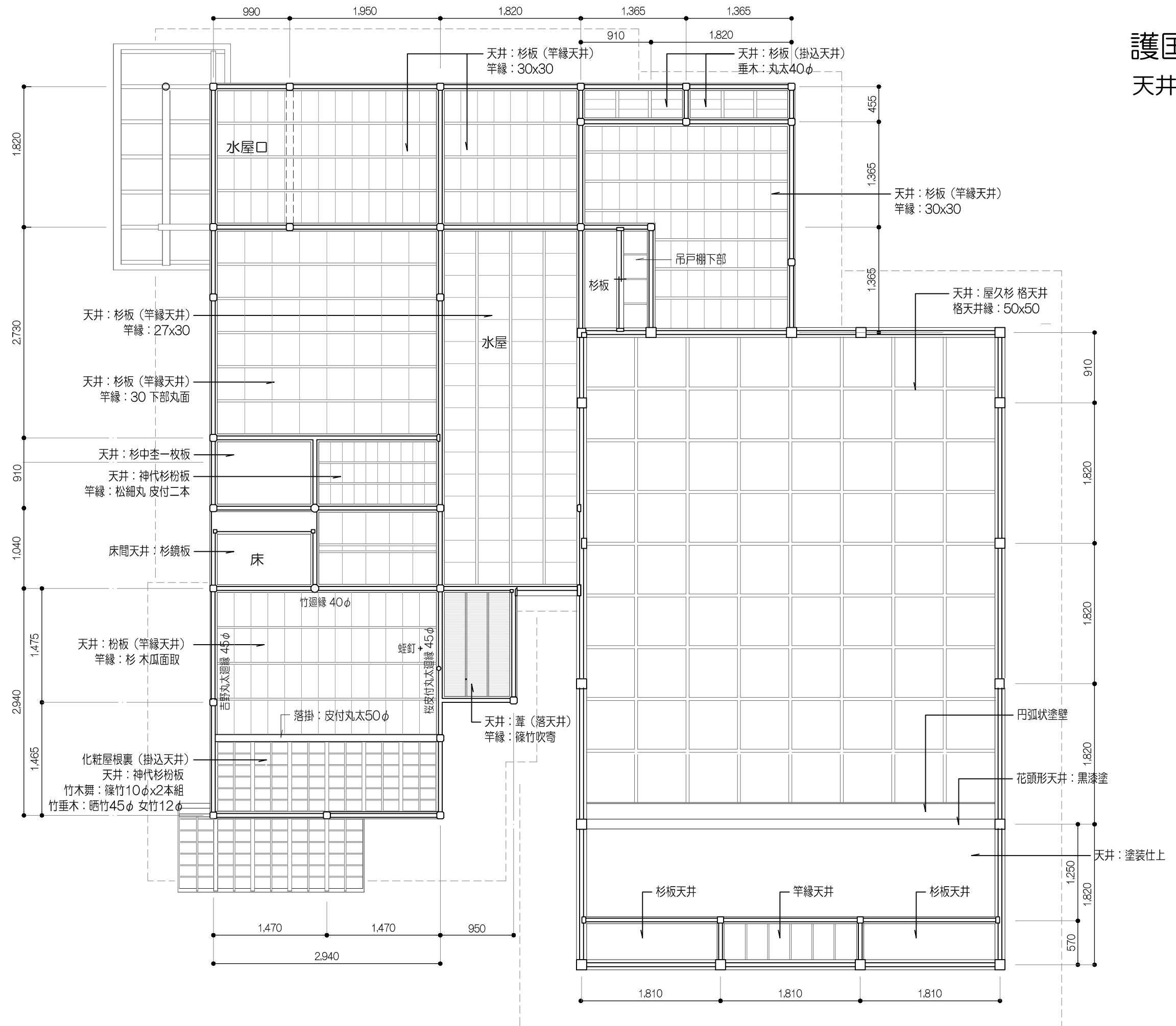

護国寺 艸雷庵 展開図1 縮尺 1:40

四畳半台目

A 面

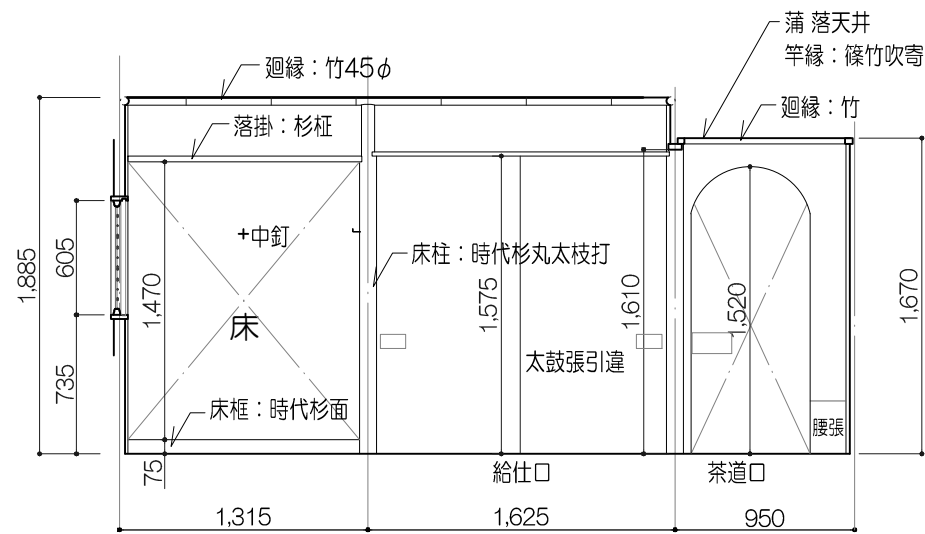

B 面

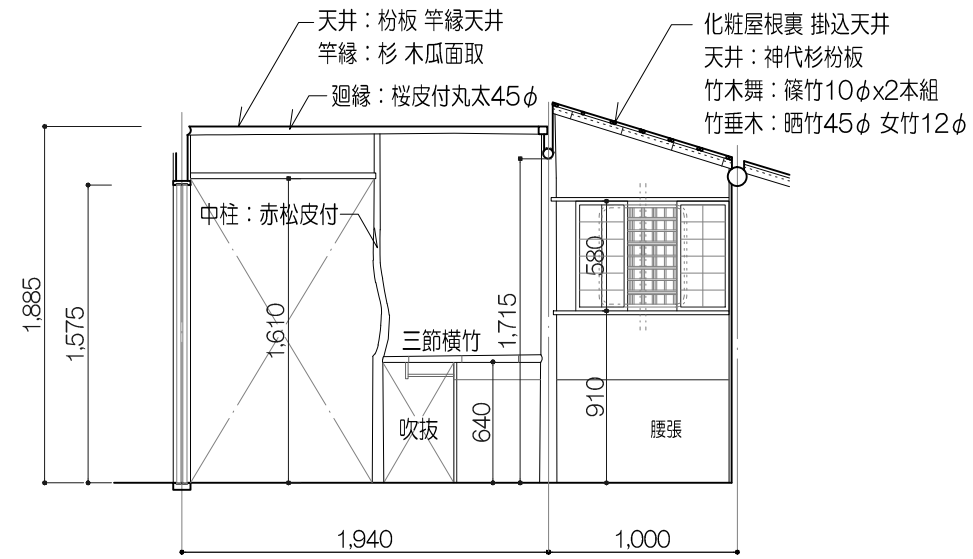

B' 面

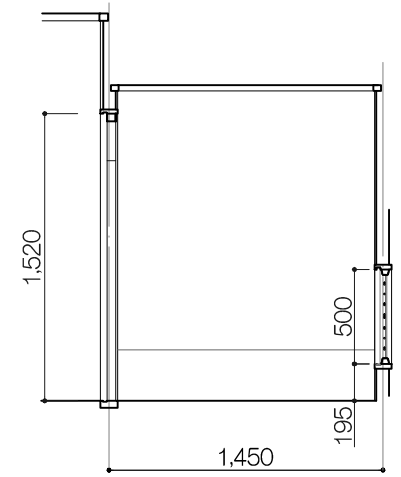

C' 面

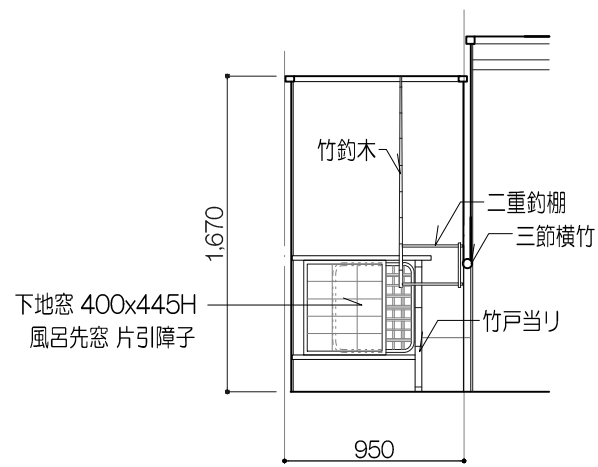

C 面

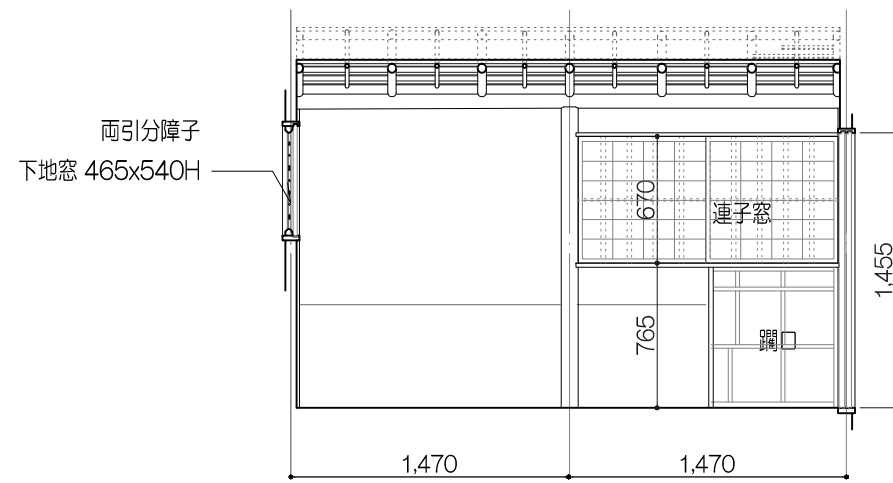

D 面

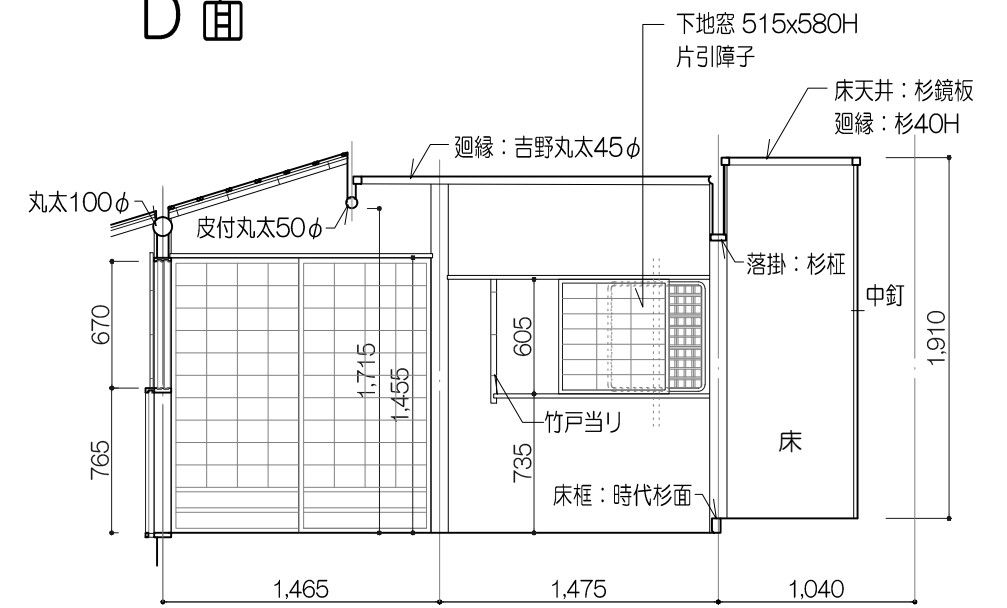

護国寺 艸雷庵 展開図2 縮尺 1:40

六畳

A面

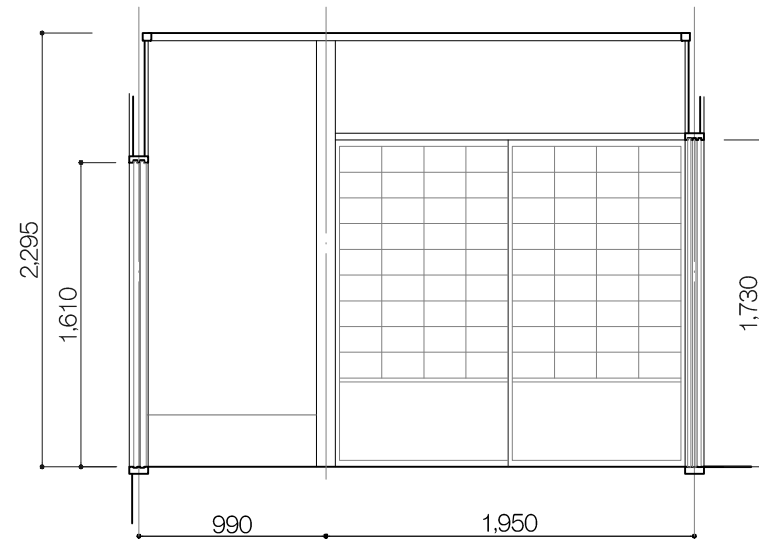

B面

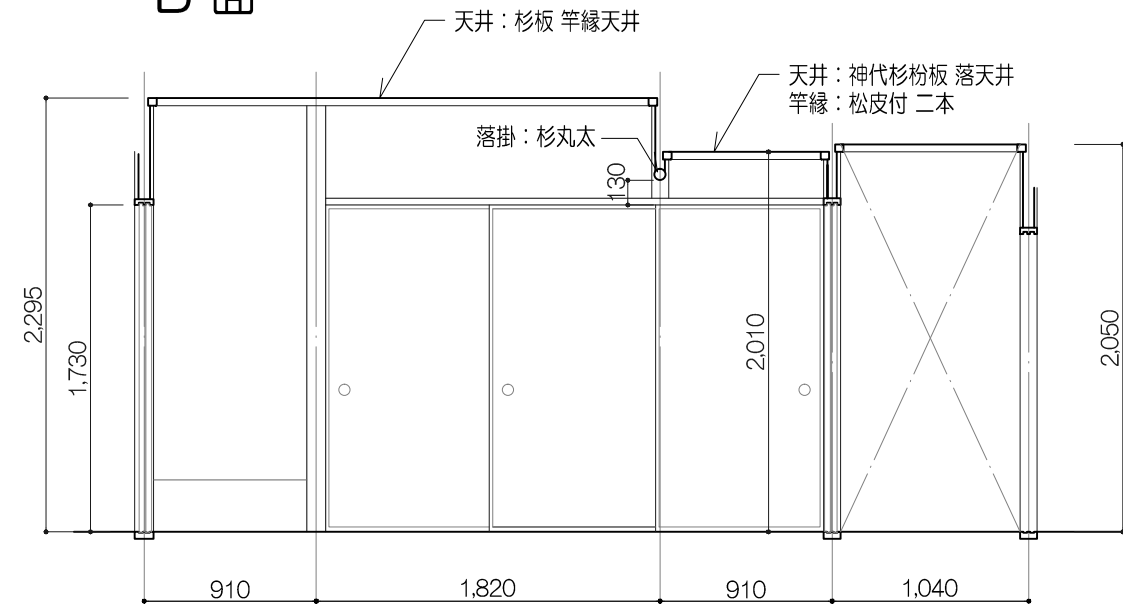

C面

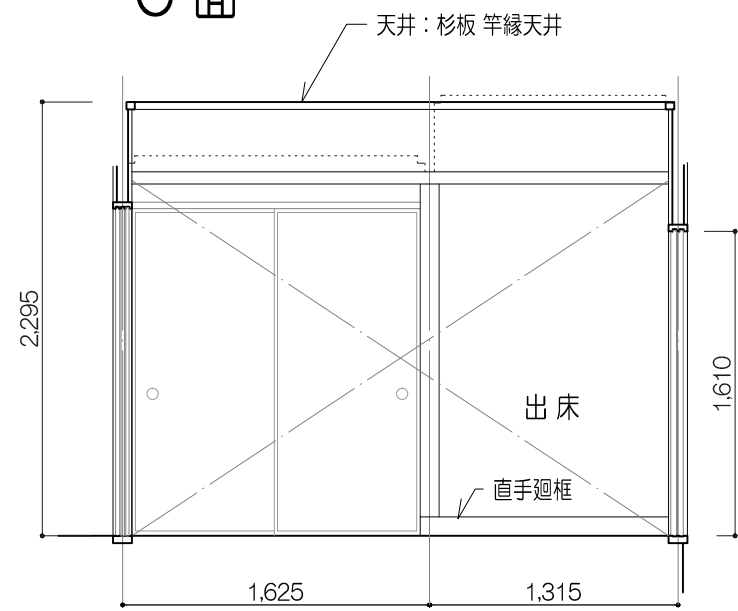

D'面

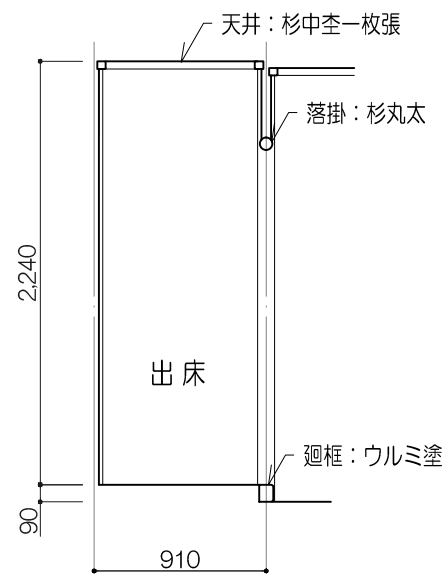

D面

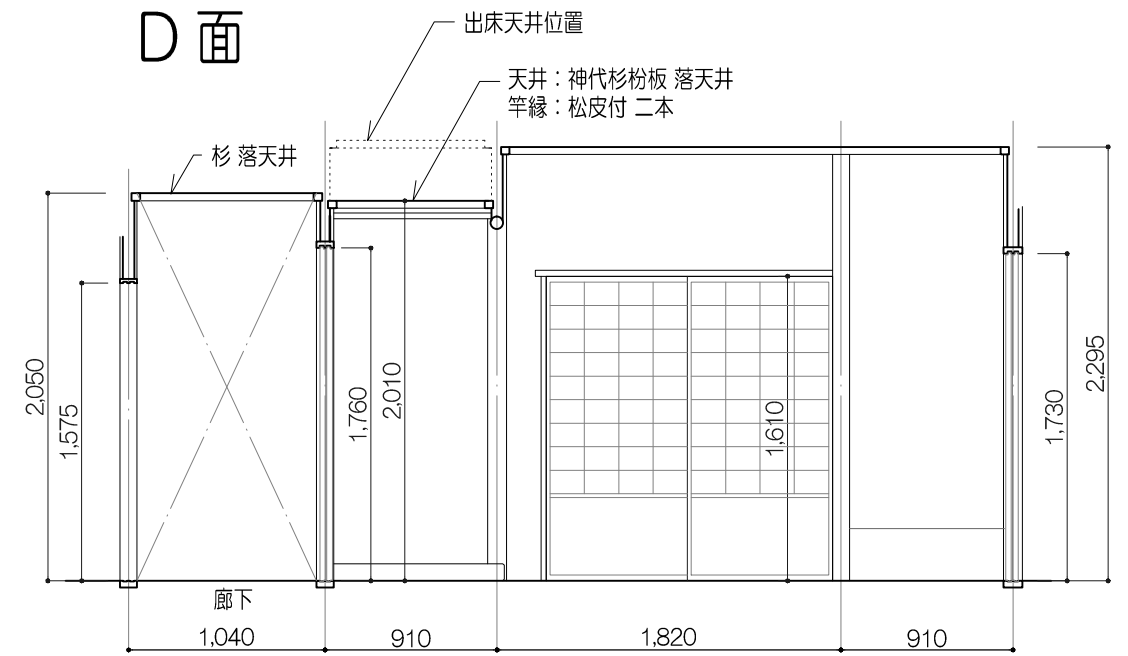

護国寺 艸雷庵 展開図3 縮尺 1 : 40

水屋

A 面

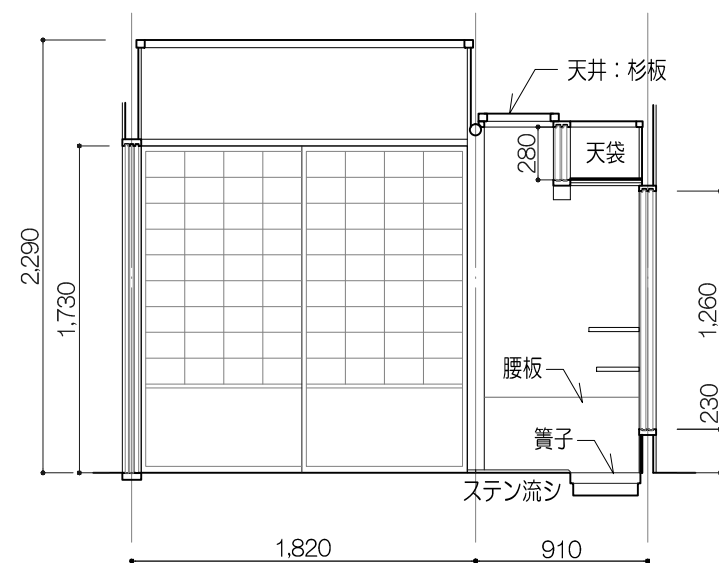

B 面

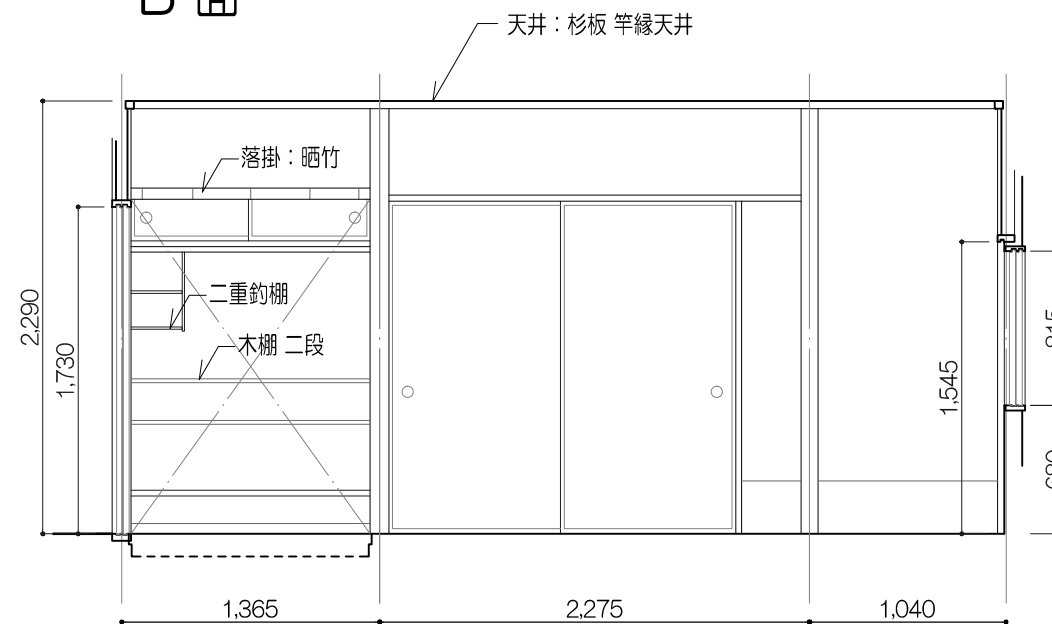

C 面

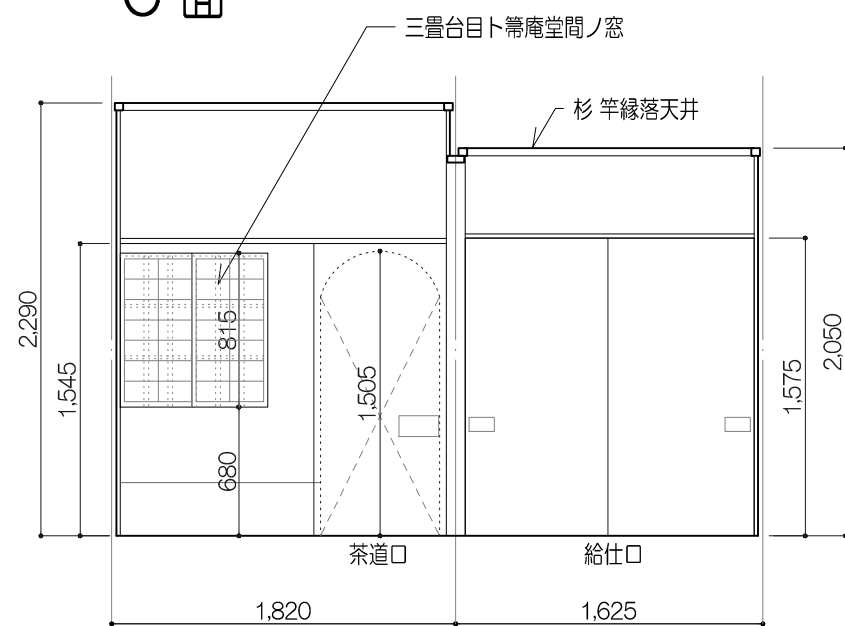

D 面

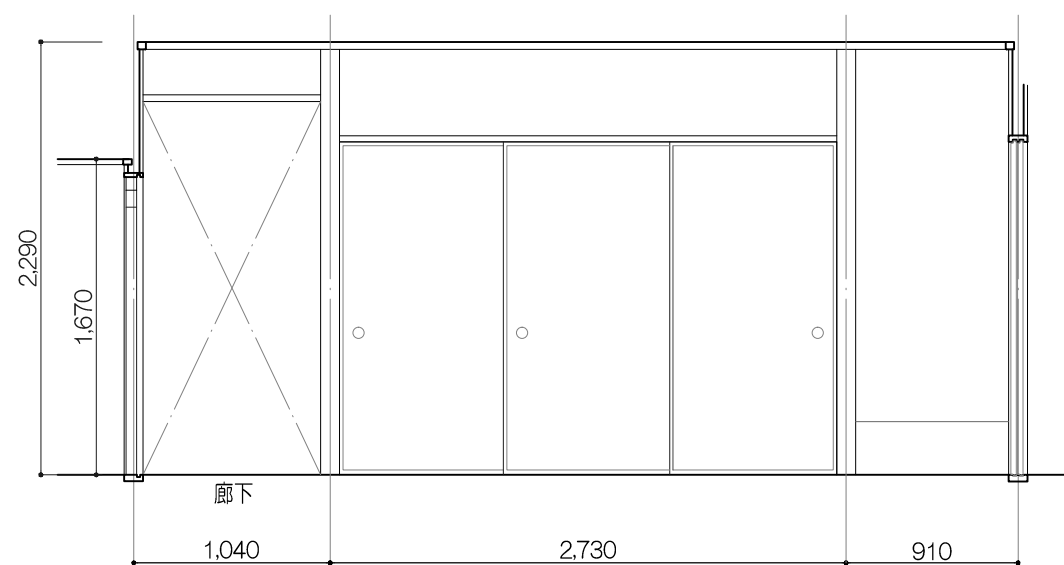

護国寺 艸雷庵 展開図4 縮尺 1:40

勝手

A 面

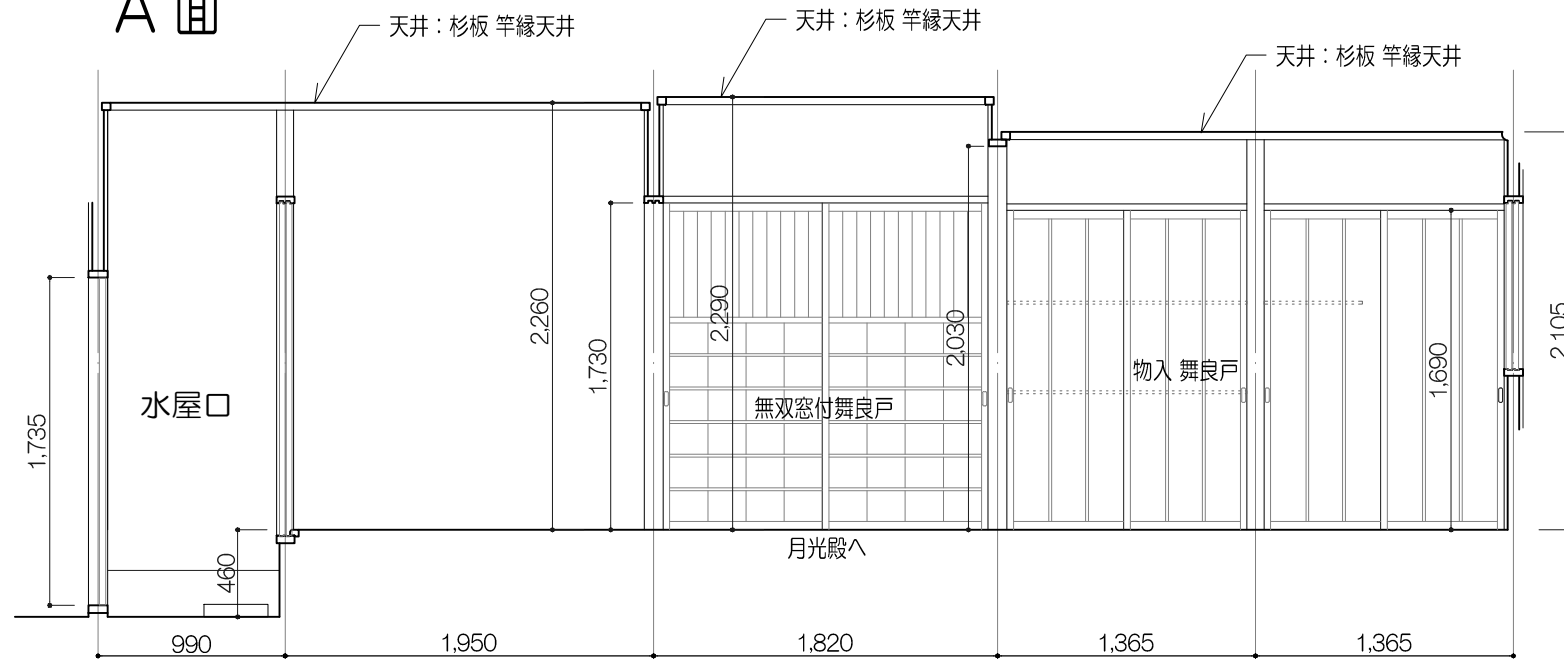

B 面

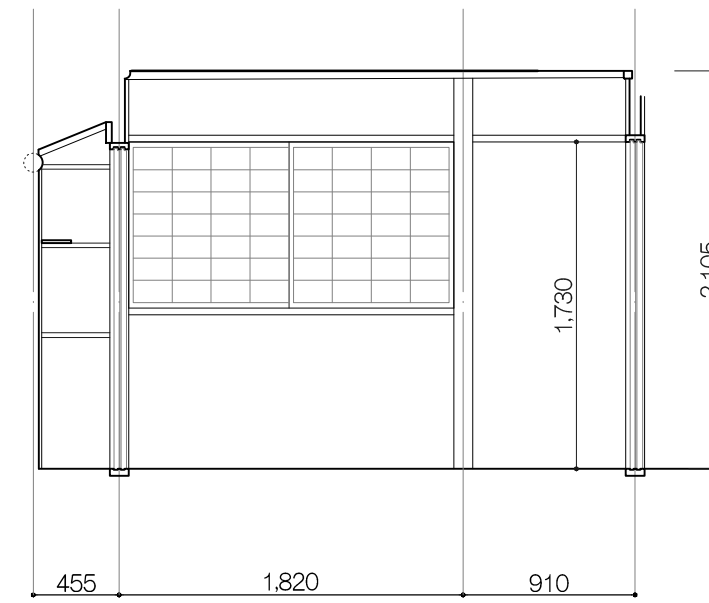

B' 面

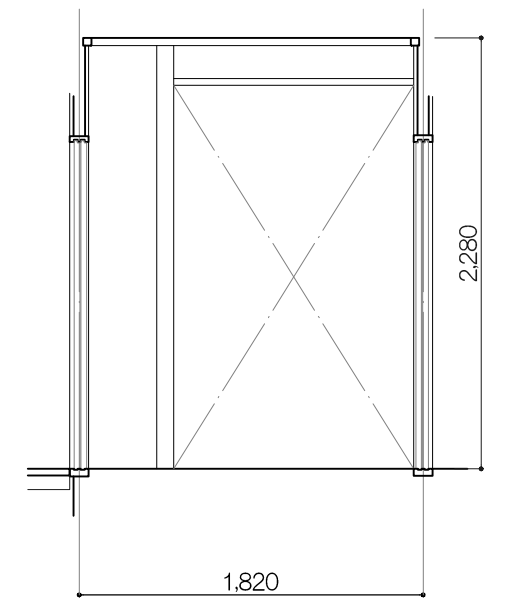

C 面

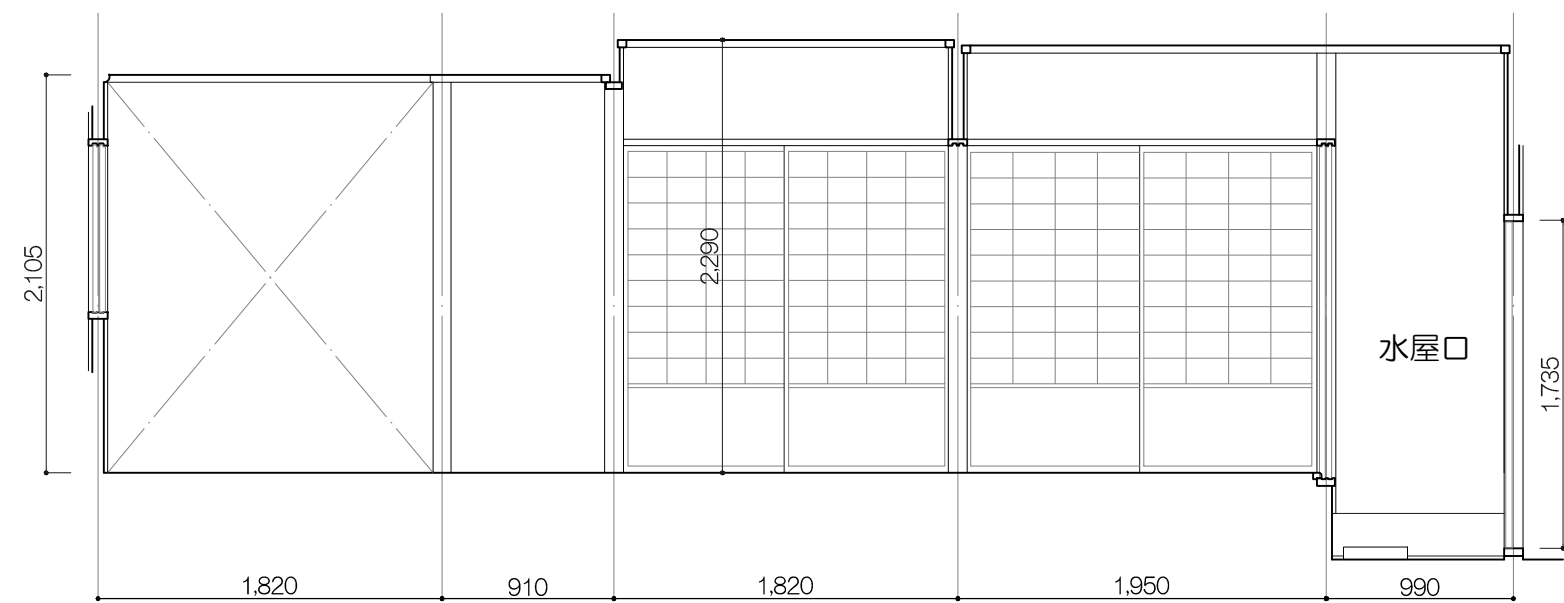

D 面

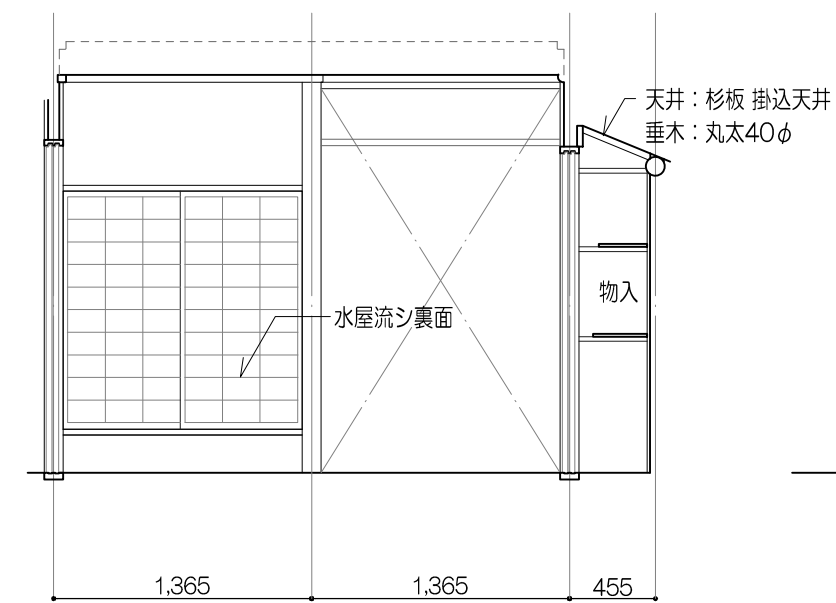

D' 面

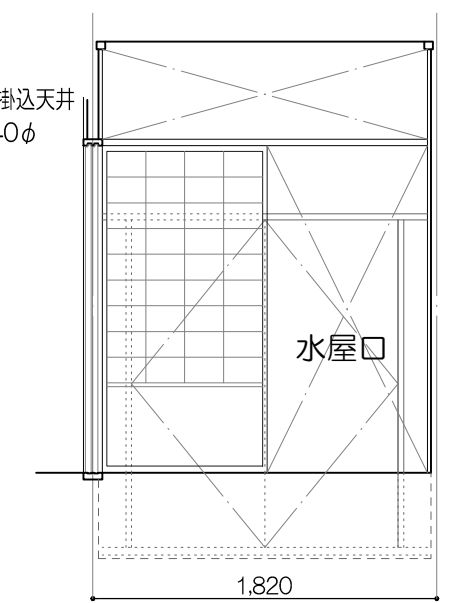

護国寺 艸雷庵 展開図5 縮尺 1:40

艸雷庵 第庵堂

A面

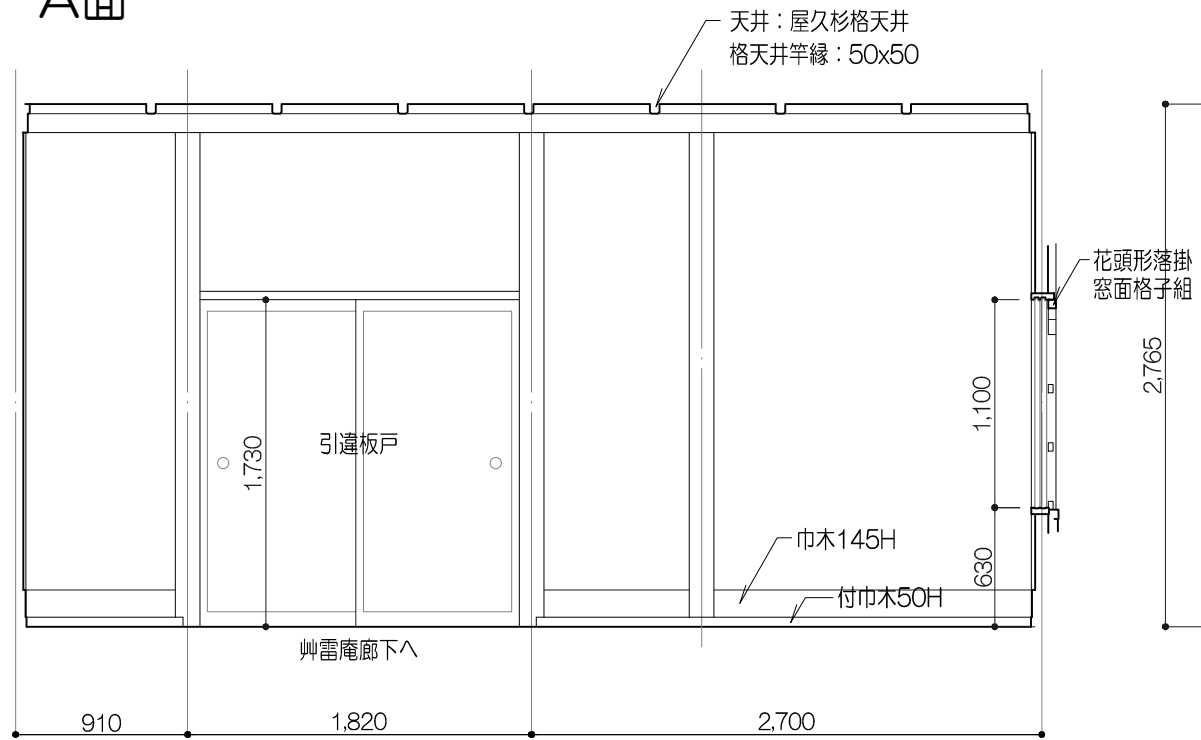

B面

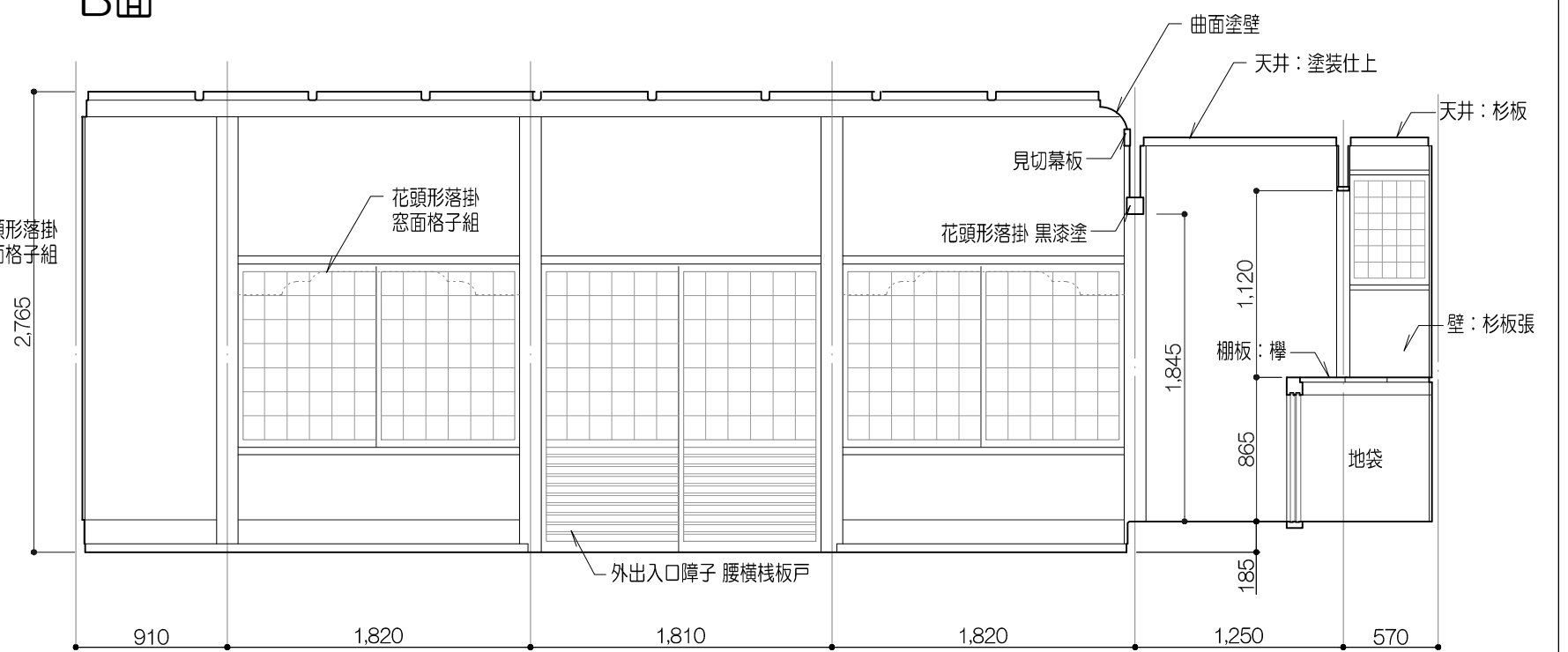

C面

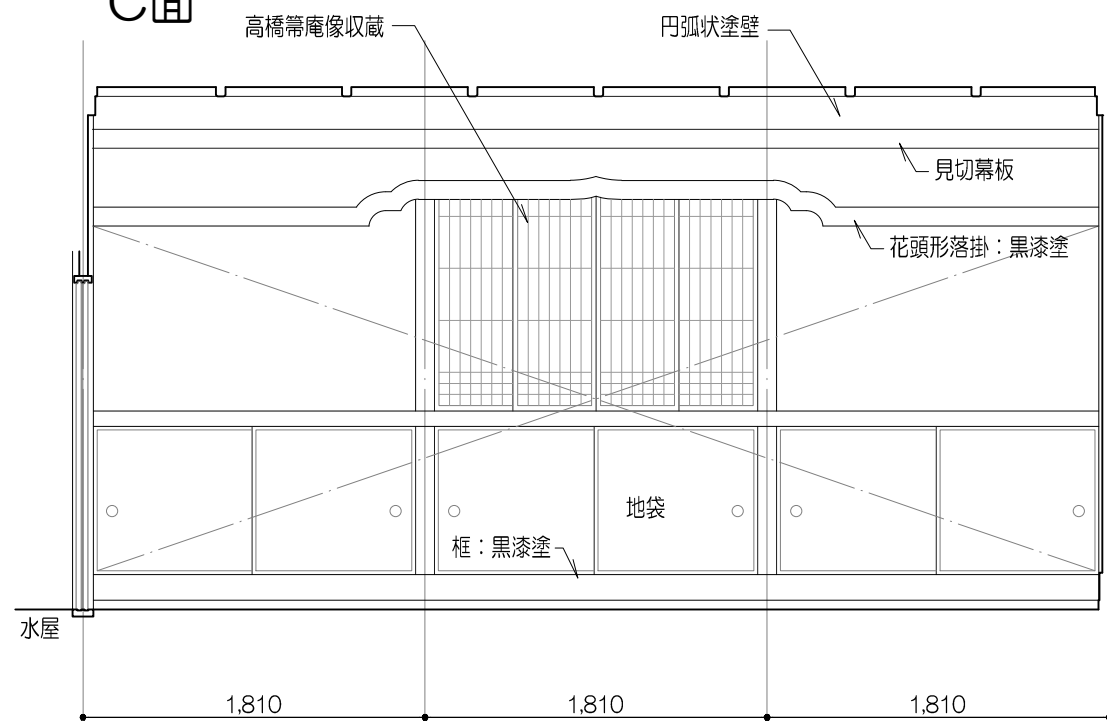

D面

