

護国寺 不味軒 圓成庵

配置図 縮尺 1:100



# 護国寺 不味軒 圓成庵

平面図 縮尺 1:50

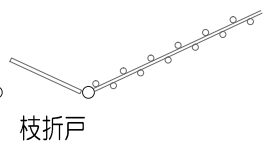
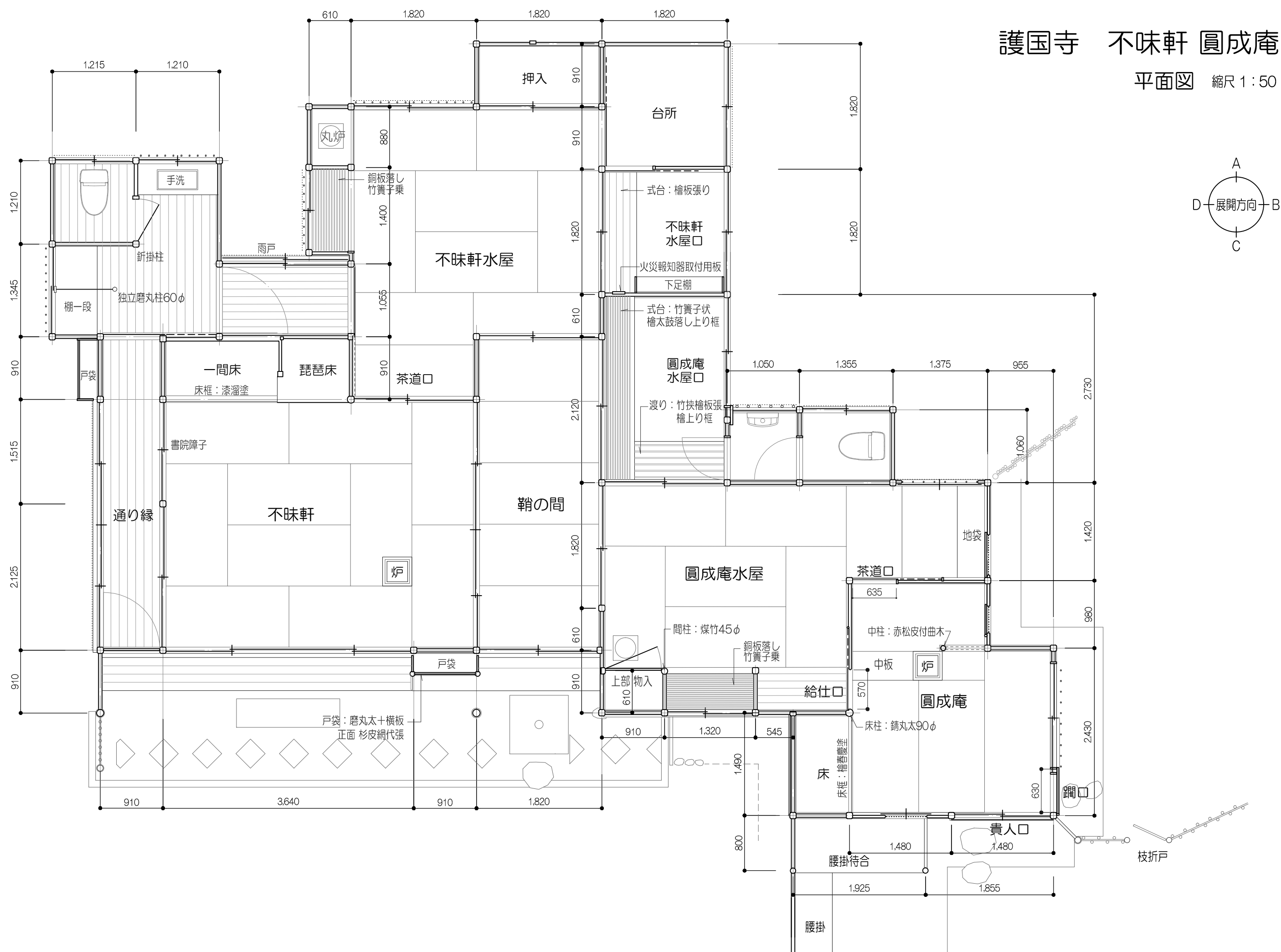
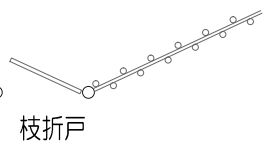
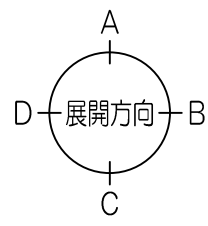
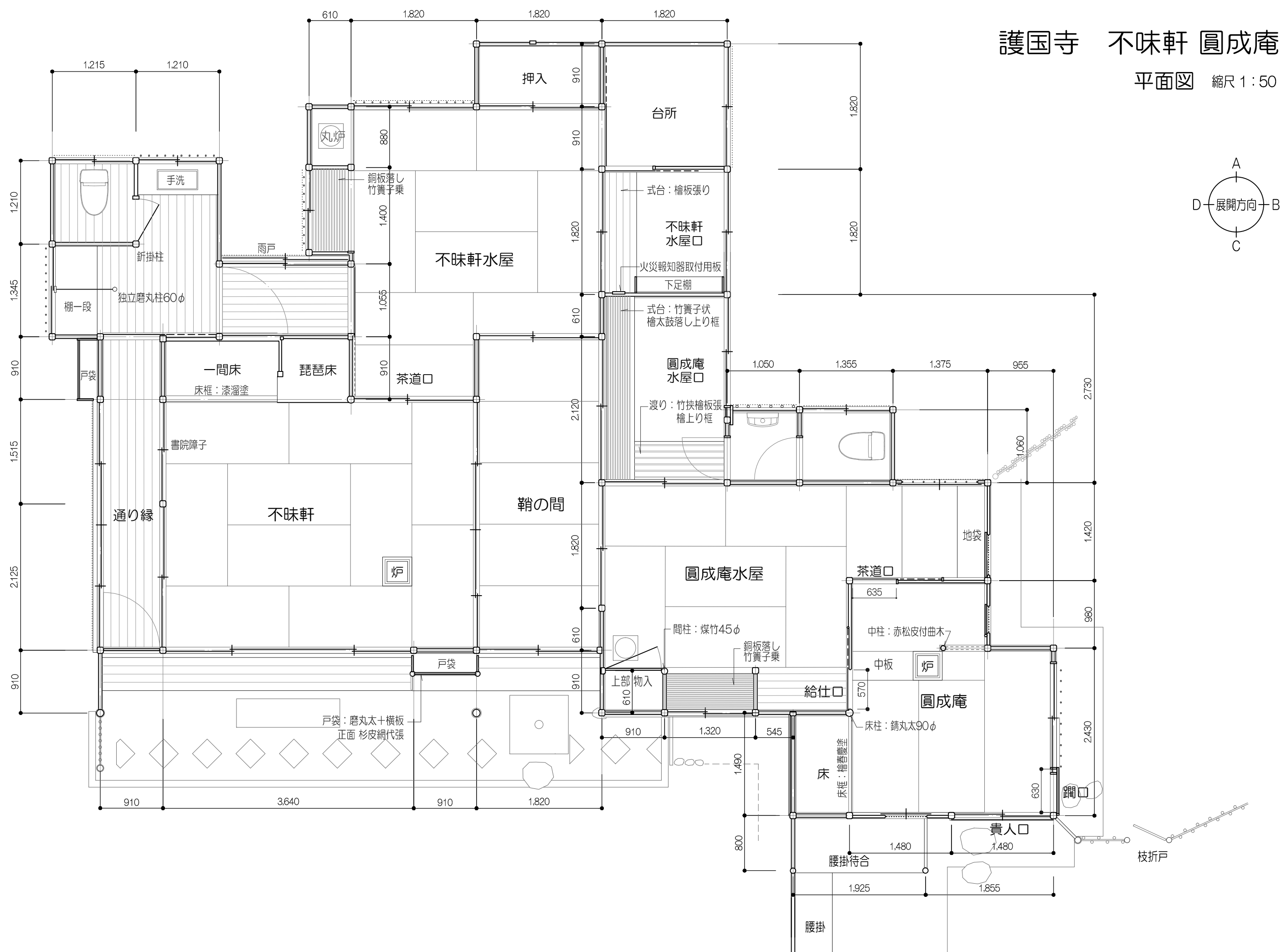

# 護国寺 不味軒 圓成庵

天井伏図 縮尺 1:50

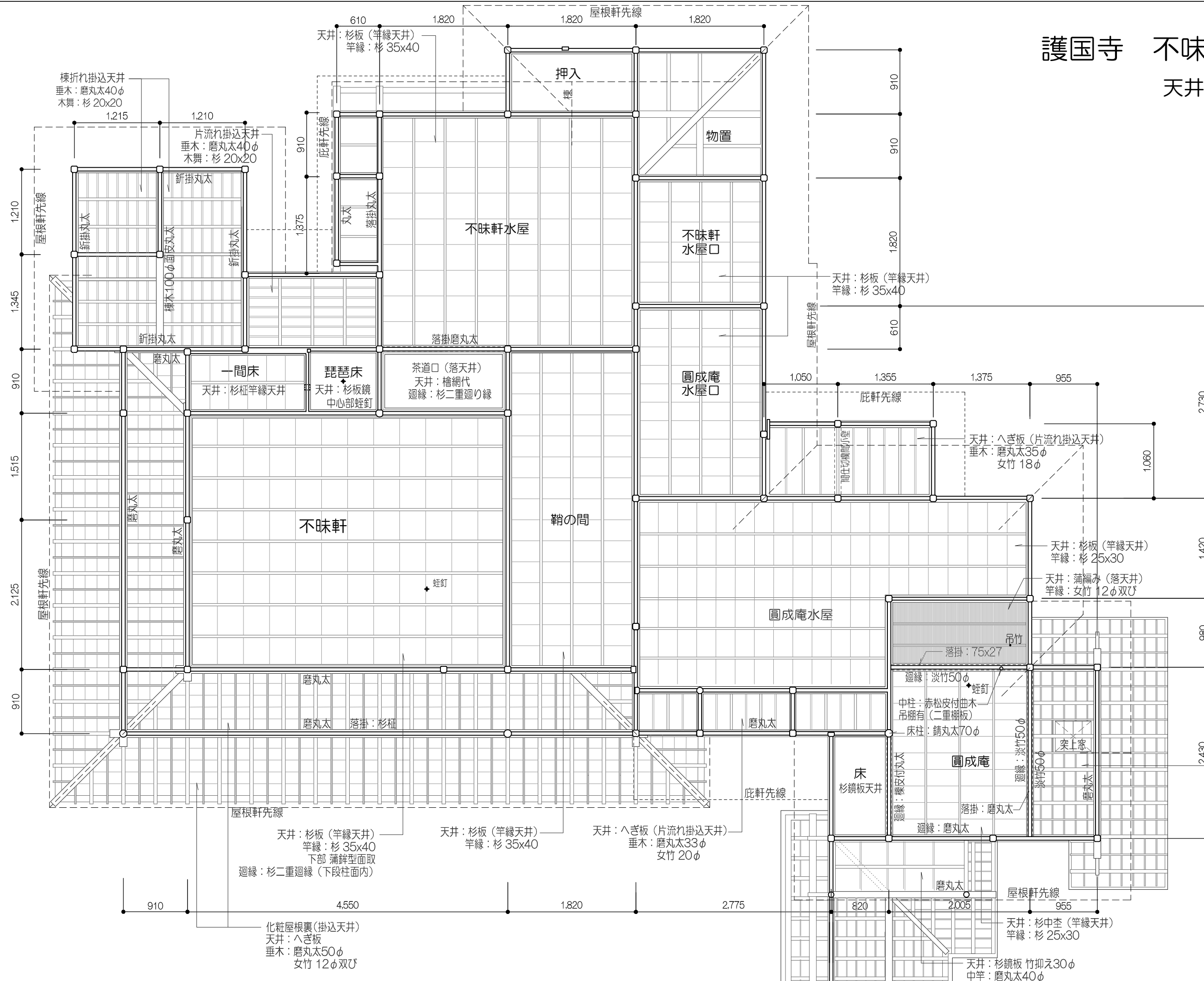

化粧屋根裏 (\*軒先裏共)  
 天井: へぎ板 (掛込天井)  
 垂木: 磨丸太50φ  
 女竹 20φ  
 竹木舞: 女竹 12φ 双び

# 護国寺 不味軒 展開図1 縮尺 1:40

注) 天井仕上等は天井伏図を参照

## 不味軒

A面 (左手:床 右手:茶道口)

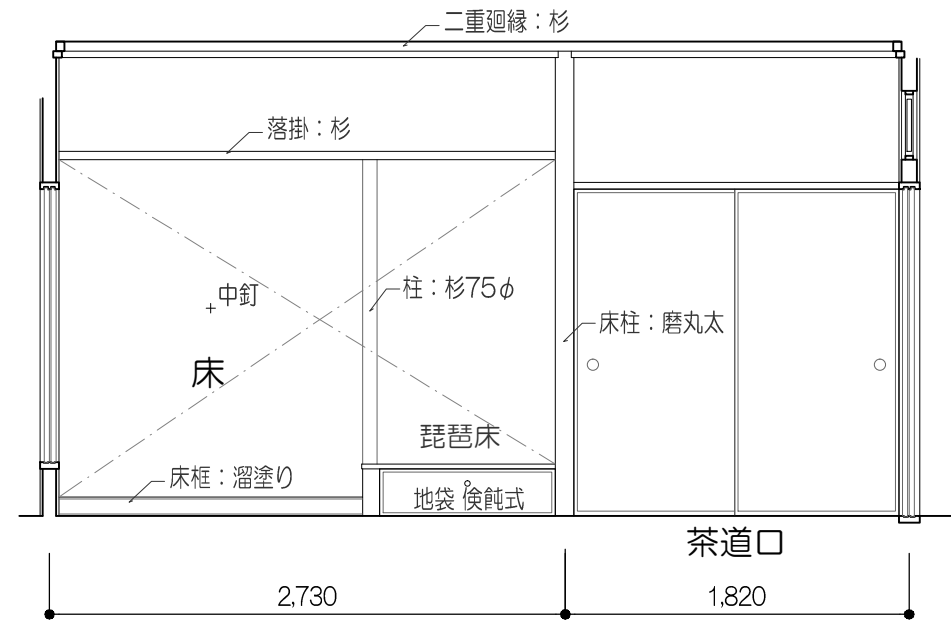

B'面 (琵琶床の側)

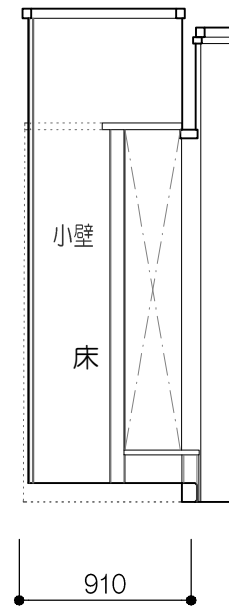

B'面

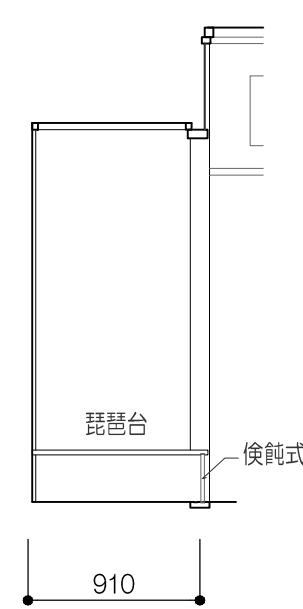

B面 (鞆の間へ通ず)

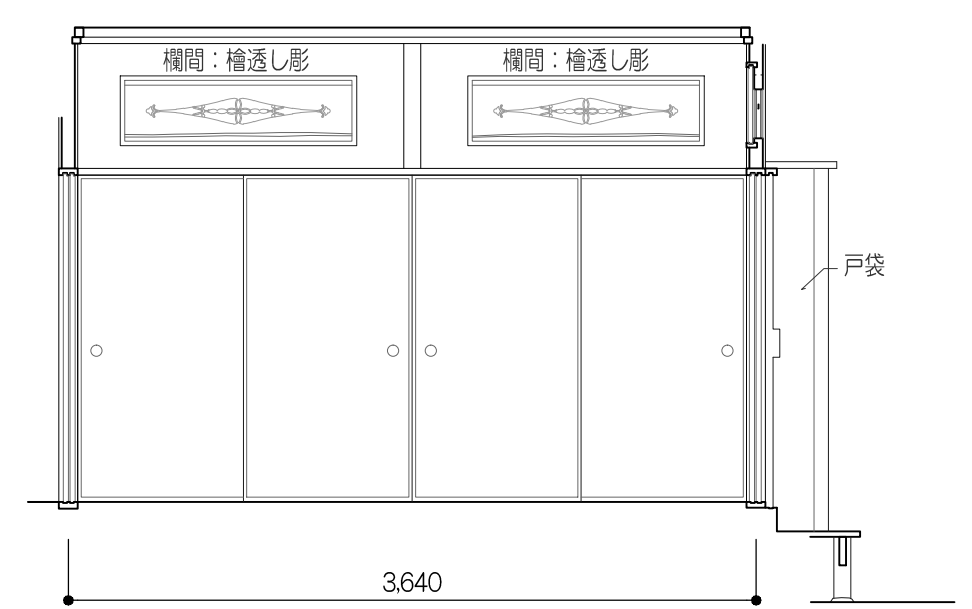

C面 (外部に面す 外雨戸)

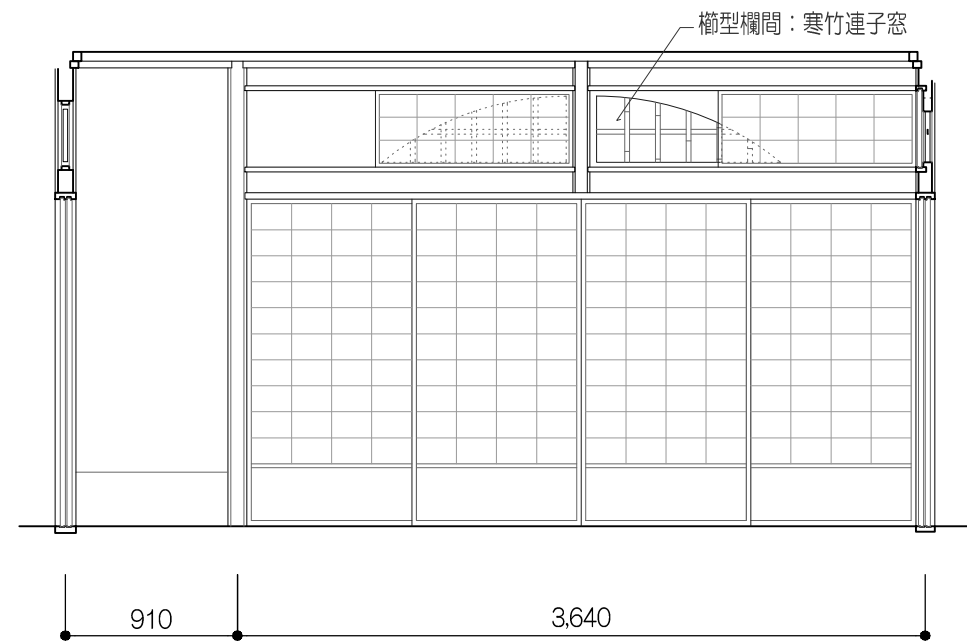

化粧屋根裏(掛込天井)

D面 (通り縁へ通ず)

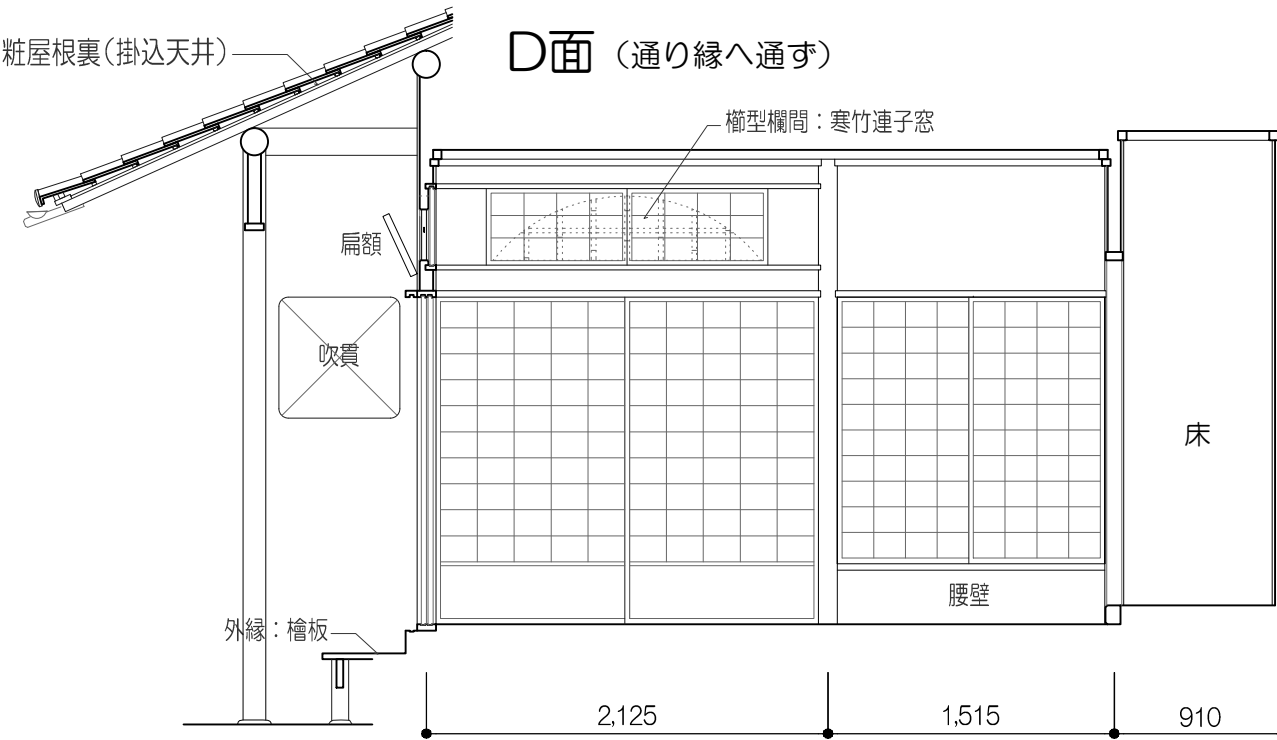

# 護国寺 不味軒 展開図2 縮尺 1:40

注) 天井仕上等は天井伏図を参照

## 不味軒水屋

A面 (外部に面す 右手: 押入)

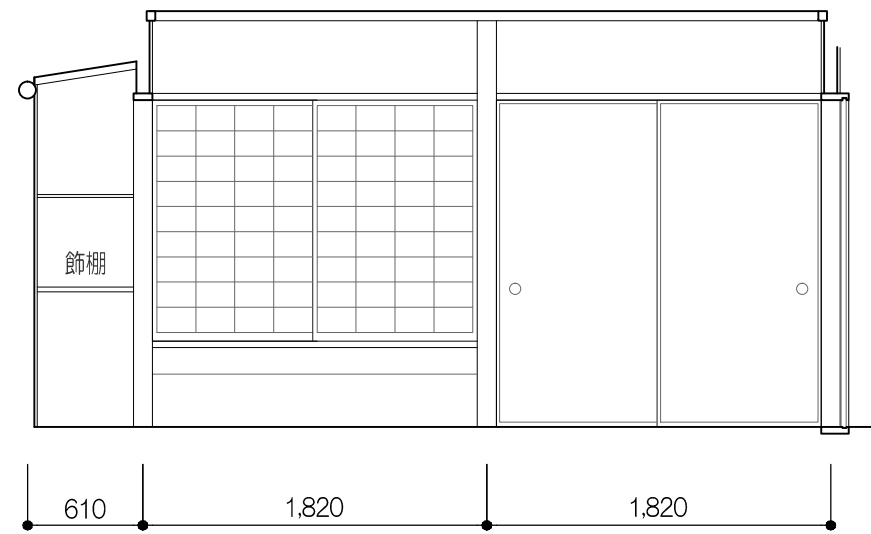

B面 (不味軒水屋口へ通ず)

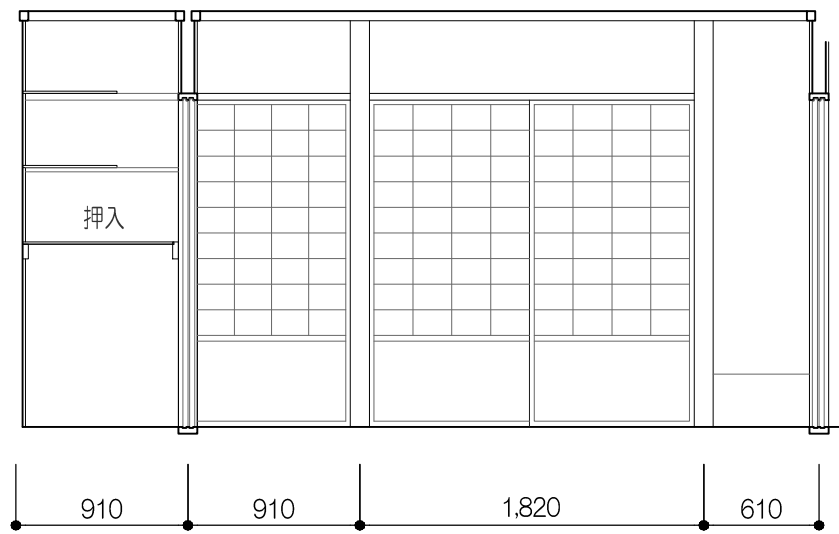

B'面 (不味軒茶道口部分)

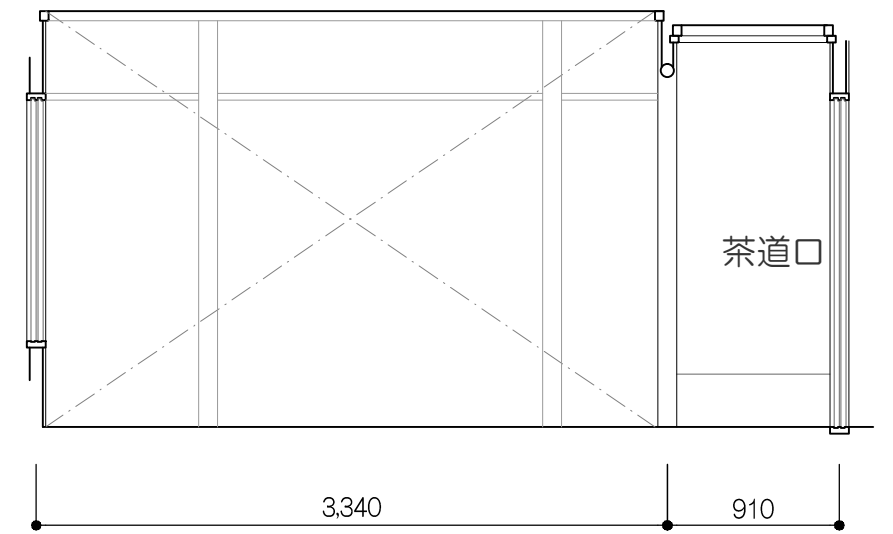

C面 (鞆の間へ通ず 右手: 不味軒茶道口)

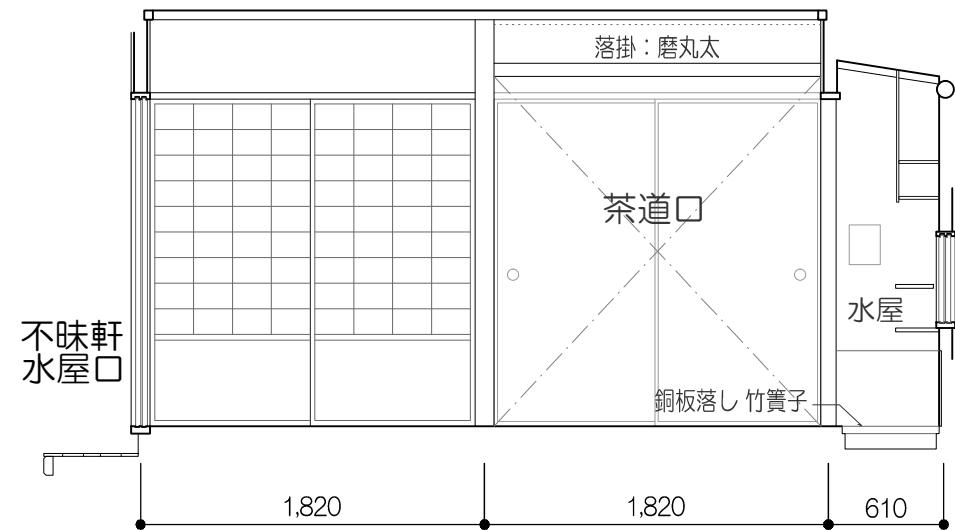

D面 (左手: 不味軒茶道口 左中: 手洗への通路)

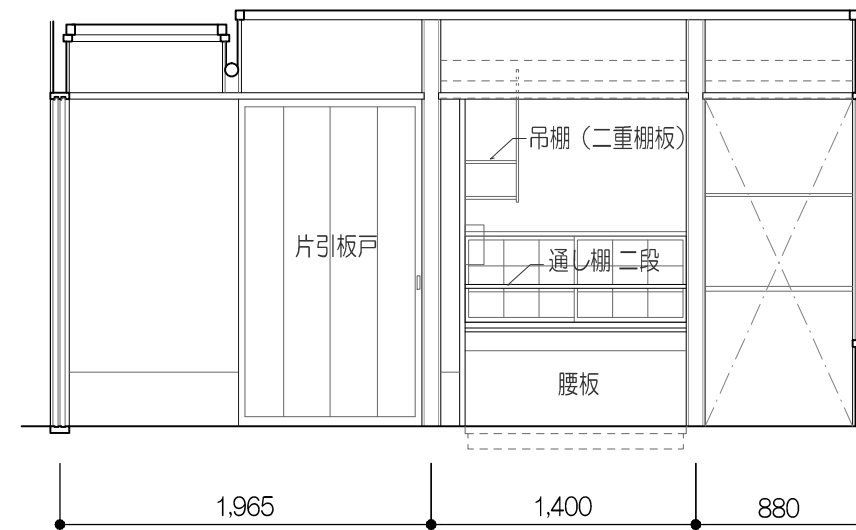

# 護国寺 不味軒 展開図3 縮尺 1:40

注) 天井仕上等は天井伏図を参照

## 鞘の間

### A面 (不味軒水屋へ通ず)

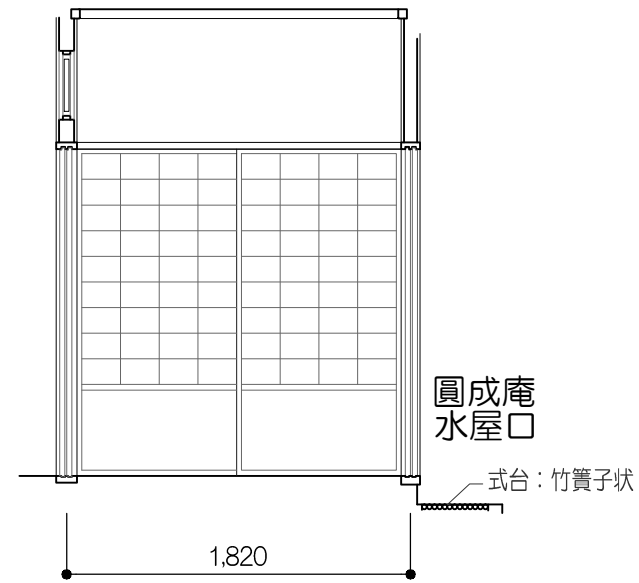

### B面 (不味軒水屋口および圓成庵水屋へ通ず)

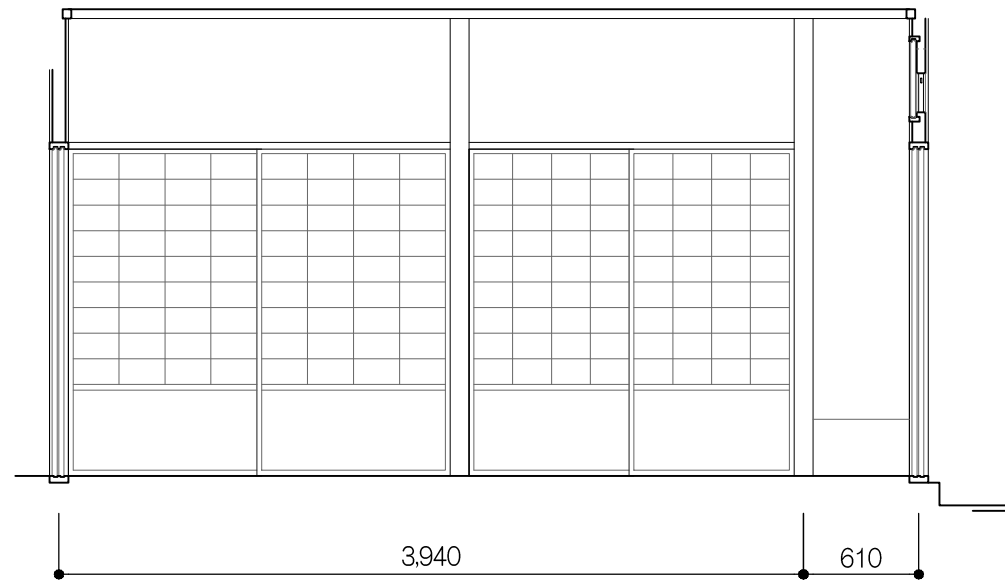

### C面 (外部に面す 外雨戸)

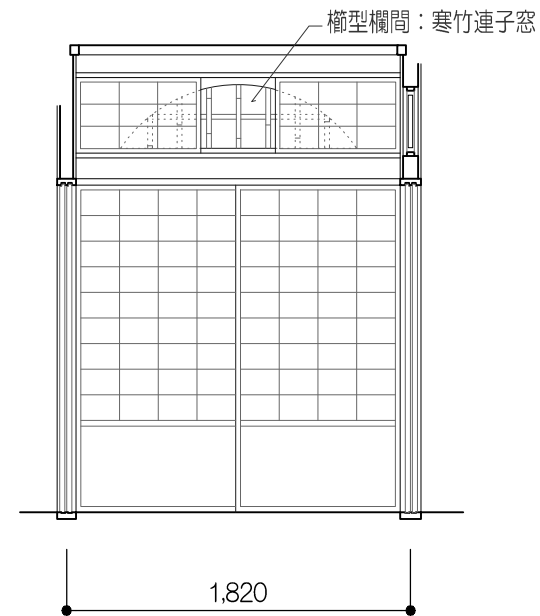

### D面 (不味軒へ通ず)

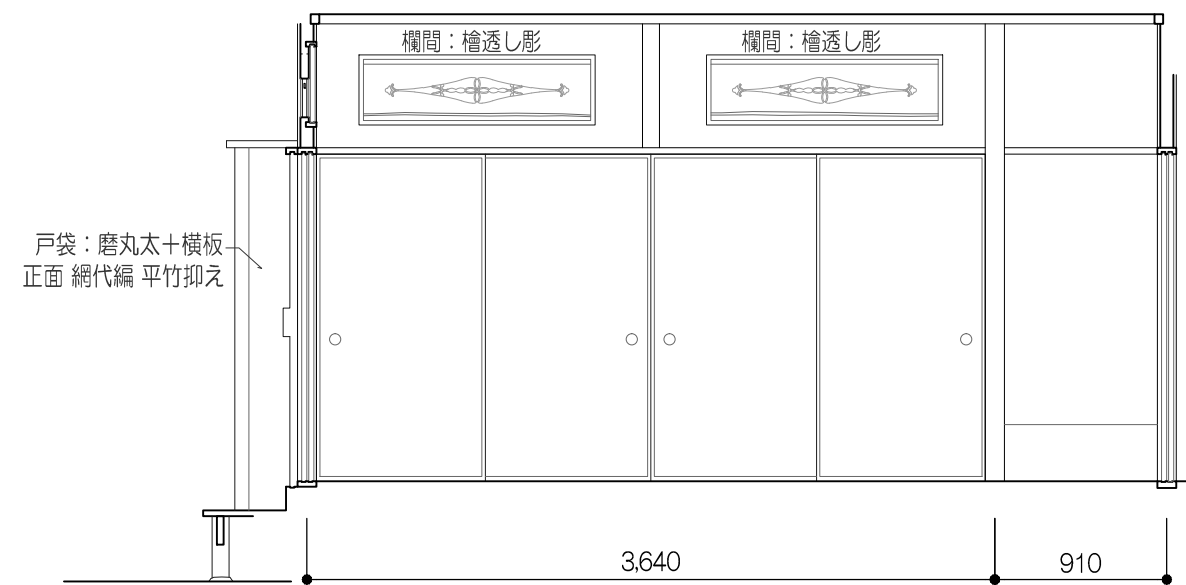

# 護国寺 圓成庵 展開図1 縮尺 1:40

注) 天井仕上等は天井伏図を参照

## 圓成庵 三疊台目

A面 (亭主席側)

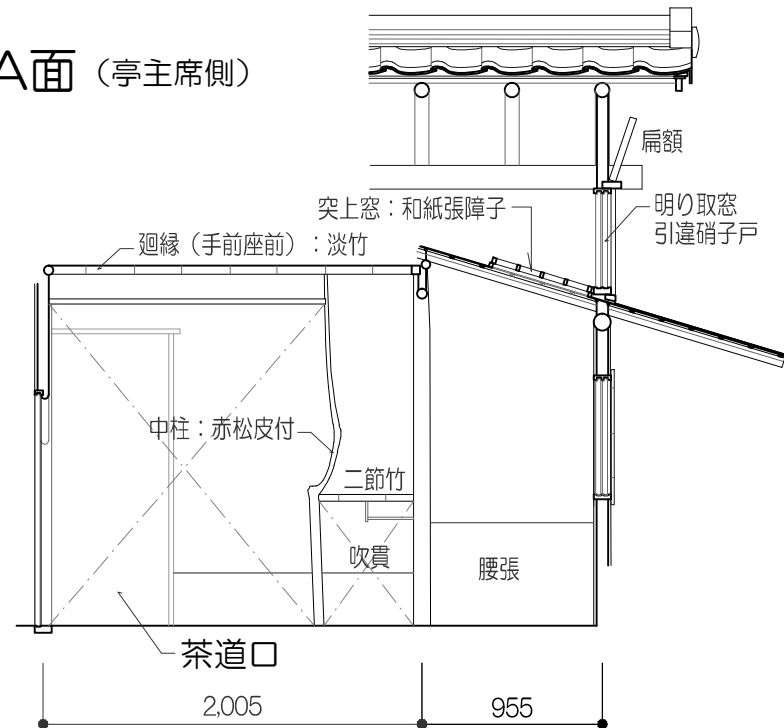

B面 (客座)

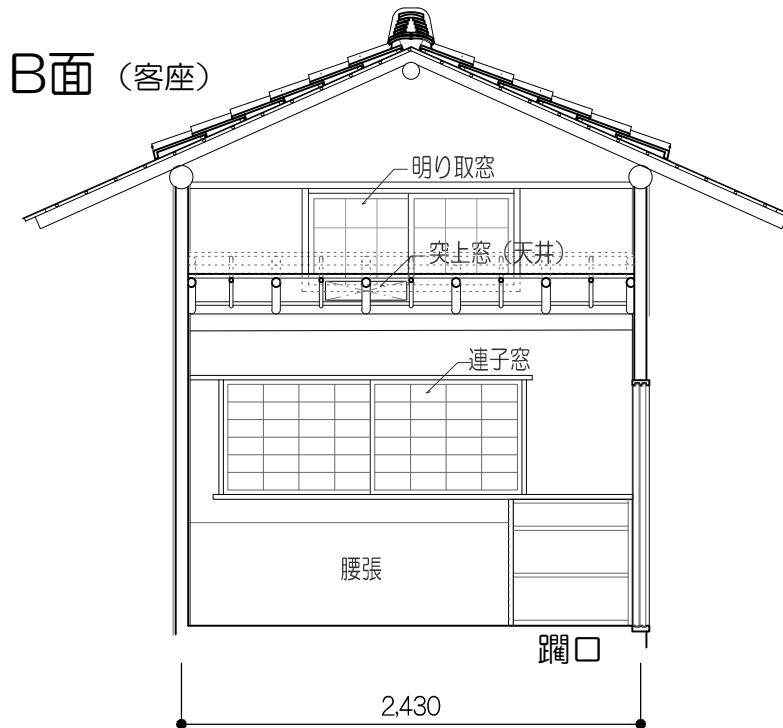

B'面 (左手: 亭主席)

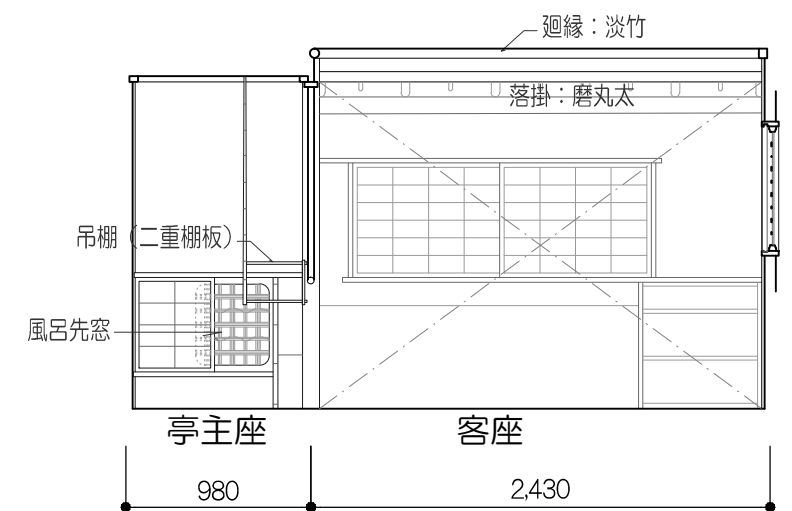

C面 (客座 外部に面す)

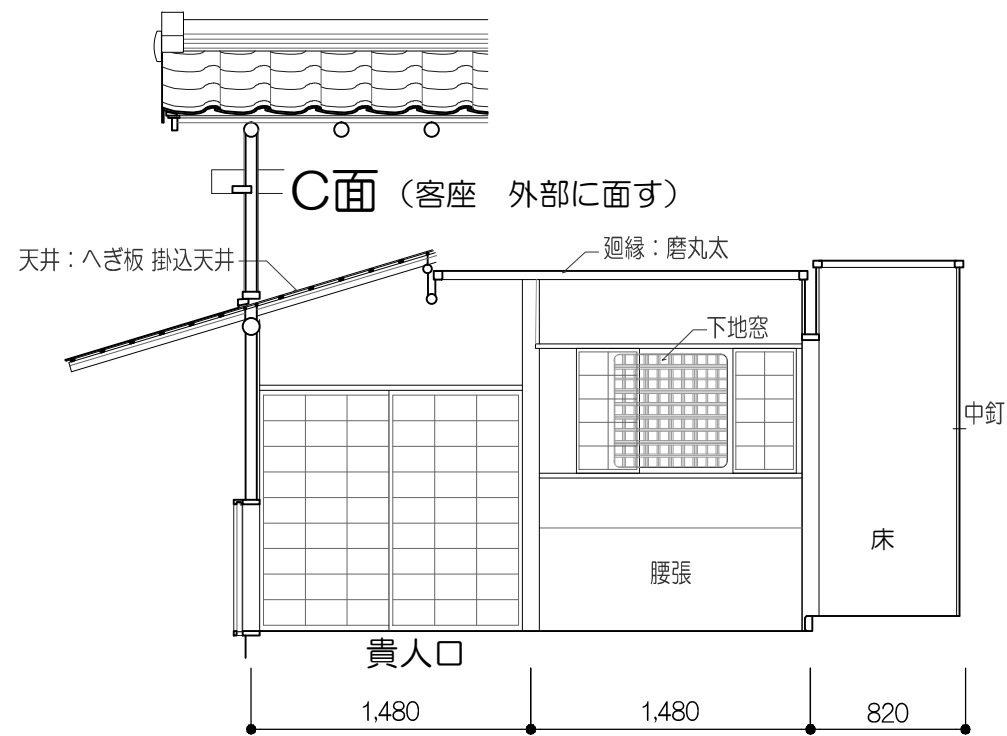

D面 (左手: 床 右手: 給仕口)

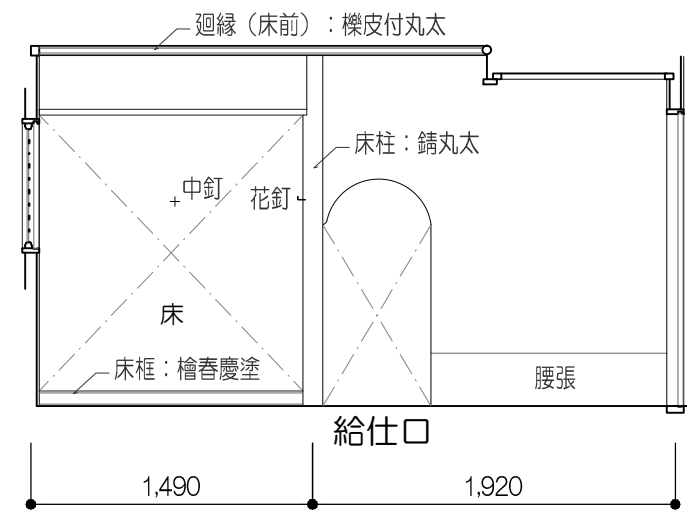

# 護国寺 圓成庵 展開図2 縮尺 1:40

注) 天井仕上等は天井伏図を参照

## 圓成庵水屋

A面 (圓成庵水屋口へ通ず 右手: 外部に面す)

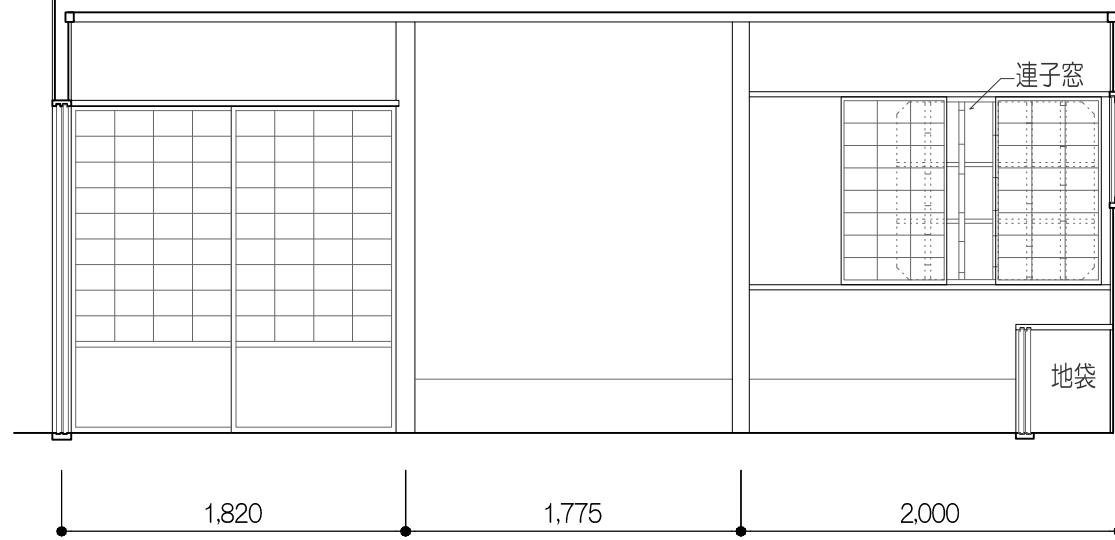

B面 (圓成庵へ通ず)

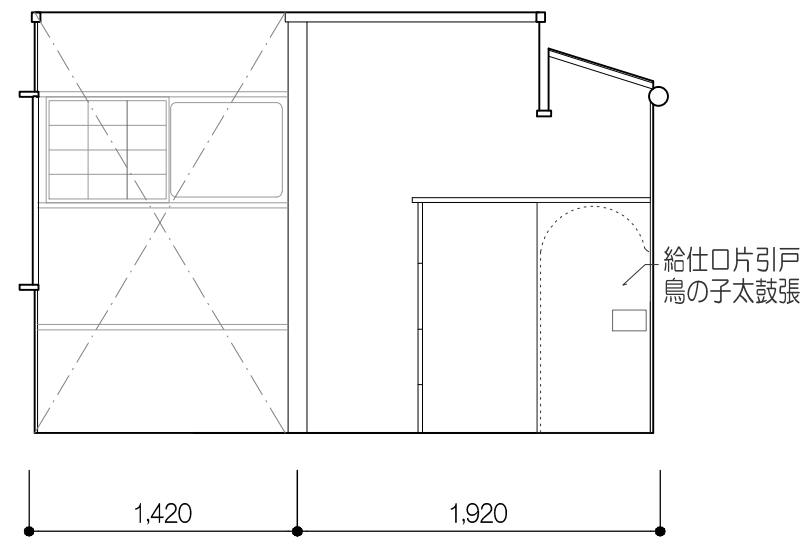

B'面 (外部に面す)

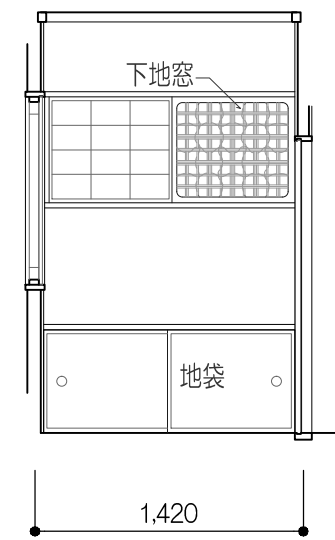

C面 (圓成庵亭主席へ通ず)

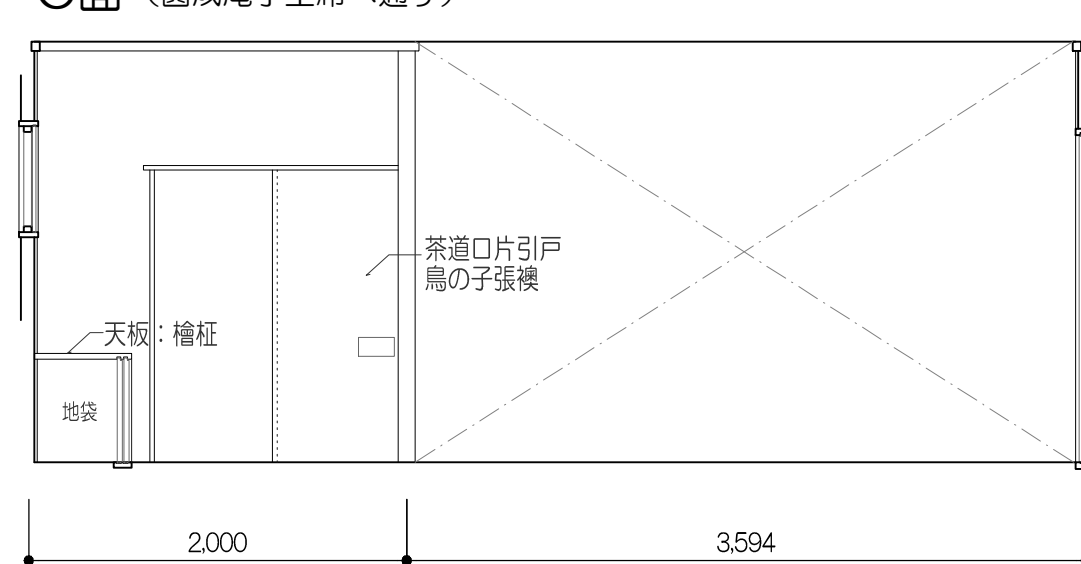

C'面 (外部に面す)

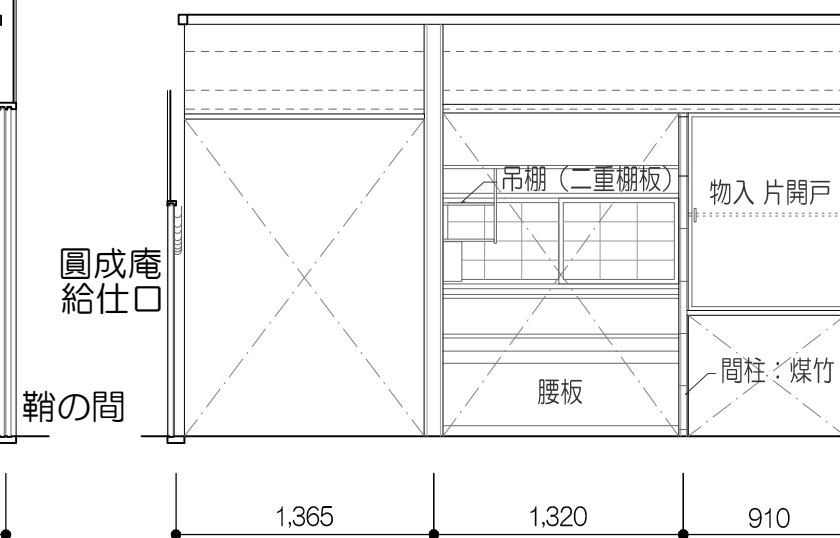

D面 (鞆の間へ通ず)

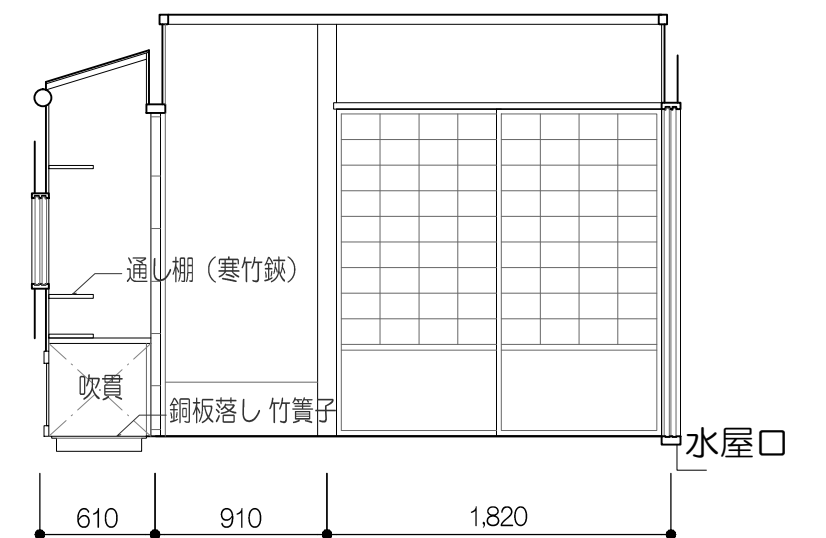

圓成庵  
給仕口

鞆の間



護国寺 不味軒 圓成庵 立面図 縮尺 1:50

東立面図

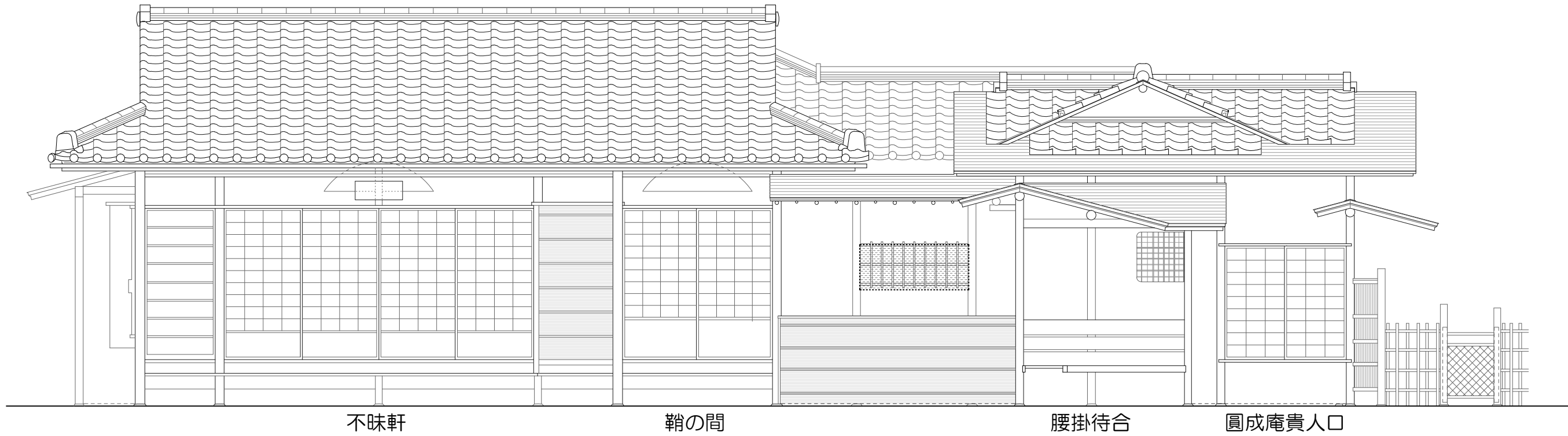

北立面図

